

TOYOTA 2007-18 TUNDRA 1.75" LEVELING KIT

Thank you for choosing Rough Country for your suspension needs.

Rough Country recommends a certified technician install this system. In addition to these instructions, professional knowledge of disassembly/reassembly procedures as well as post installation checks must be known. Attempts to install this system without this knowledge and expertise may jeopardize the integrity and/or operating safety of the vehicle.

Please read instructions before beginning installation. Check the kit hardware against the parts list on this page and the product layout on the last page. Be sure you have all needed parts and know where they go. Also please review tools needed list and make sure you have needed tools.

PRODUCT USE INFORMATION

▲WARNING As a general rule, the taller a vehicle is, the easier it will roll. Seat belts and shoulder harnesses should be worn at all times. Avoid situations where a side rollover may occur. Generally, braking performance and capability are decreased when larger/heavier tires and wheels are used. Take this into consideration while driving. Do not add, alter, or fabricate any factory or after-market parts to increase vehicle height over the intended height of the Rough Country product purchased. Mixing component brands is not recommended.

Rough Country makes no claims regarding lifting devices and excludes any and all implied claims. We will not be responsible for any product that is altered. If questions exist about the design, function, installation, and correct use of our products please call one of our customer service representatives at 800-222-7023.

This suspension system was developed using a Maximum tire size of 285/65 -18 tire with factory wheels. For aftermarket wheel and tire combinations consult your tire and wheel specialist.

▲NOTICE NOTICE TO DEALER AND VEHICLE OWNER

Any vehicle equipped with any Rough Country product should have a "Warning to Driver" decal installed on the inside of the windshield or on the vehicle's dash. The decal should act as a constant reminder for whoever is operating the vehicle of its unique handling characteristics.

INSTALLING DEALER - it is your responsibility to install the warning decal and forward these installation instructions on to the vehicle owner for review. These instructions should be kept in the vehicle for its service life.

KIT CONTENT:

2-Front Strut Spacers
1-88000BAG1 Kit Bag that includes:
8-10mm x 50mm Bolts
8-10mm Flange Lock Nuts

TOOLS NEEDED:

Hammer
9/16" Wrench
13/16" Wrench
10mm Wrench/Socket
12mm Wrench/Socket
14mm Wrench/Socket
17mm Wrench/Socket
19mm Wrench/Socket
22mm Wrench
Torque Wrench
Thread Locker
Jack
Jack Stands

TORQUE SPECS

Size	Grade 5	Grade 8
3/8"	30 ft/lbs	35 ft/lbs
9/16"	95 ft/lbs	130 ft/lbs
Metric		
8mm	25ft/lbs	
10mm	42 ft/lbs.	
12mm	70 ft/lbs.	
14mm	95 ft/lbs.	
16mm	200ft./lbs	
18mm	475ft./lbs	



FRONT INSTALLATION

1. Park the vehicle on a level surface and chock the rear wheels.
2. Jack up the front of the vehicle using a floor jack. Place jack stands under the frame rails directly behind the lower control arms and lower the vehicle onto the jack stands.
3. Remove the tires and wheels.
4. Remove the sensor wire bracket, using a 10MM wrench. **Take care not to overextend or damage this wire.** Retain the hardware for reuse. **See Photo 1.**
5. Remove the upper strut nuts, using a 14MM wrench. **See Photo 2.**

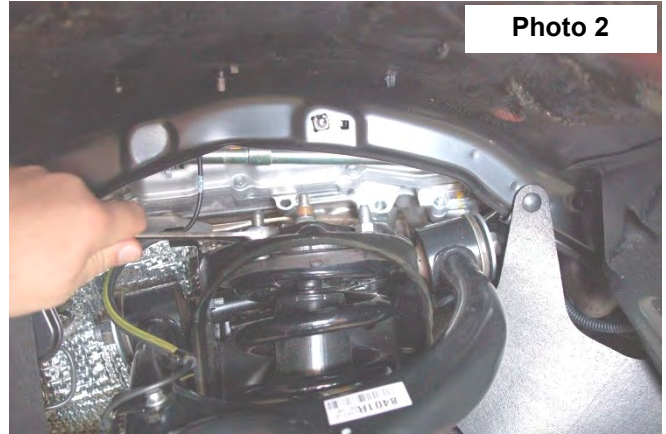
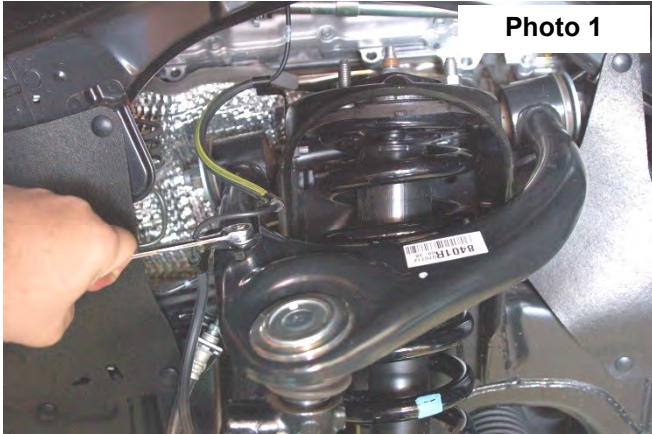

6. Remove the sway bar link from the lower control arms using a 19MM wrench. Retain hardware. **See Photo 3.**
7. Loosen , but do not remove the lower control arm bolts to allow the lower control arm to swing down using a 24MM

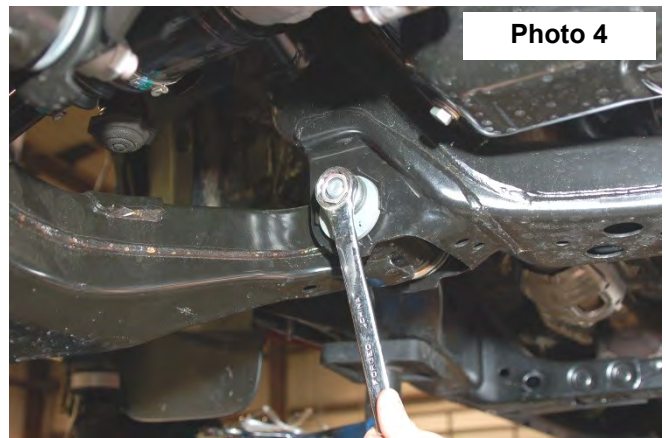
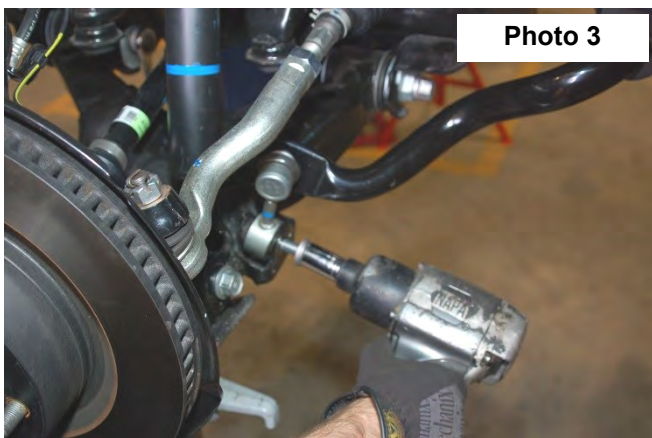

8. Remove the brake line bracket from the knuckle using a 12MM wrench. Retain hardware for reuse.
9. Support the lower control arm with a jack or jack stand.
10. Loosen the upper ball joint nut using a 19MM wrench as shown in. Hit side of the knuckle, with a hammer, to brake the taper lock loose. **See Photo 5.**

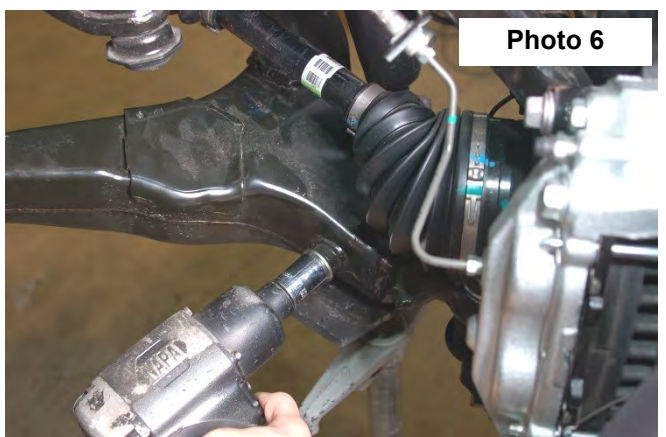

12. Install the supplied 10mm x 50mm bolts through the underside of the strut spacer. **See Photo 7.**
13. Install the spacer on the top of the strut using the stock nuts. **Torque to 42 ft/lbs.** The side marked "FRAME" should point towards the frame. **See Photo 8.**

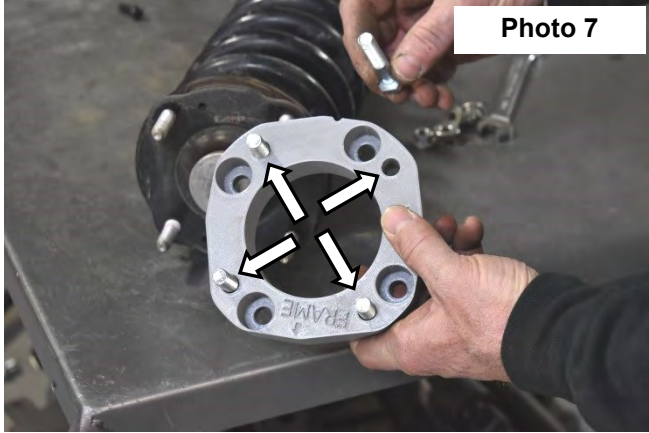

Photo 7



Photo 8

14. Mark the coil and the rubber stub on the top hat using a paint pen. **See Photo 9.**
15. Place the strut in a strut compressor and rotate the top hat until the groove in the spacer lines up with the marking on the coil or until the paint markings are 1" apart. **See Photo 10.**

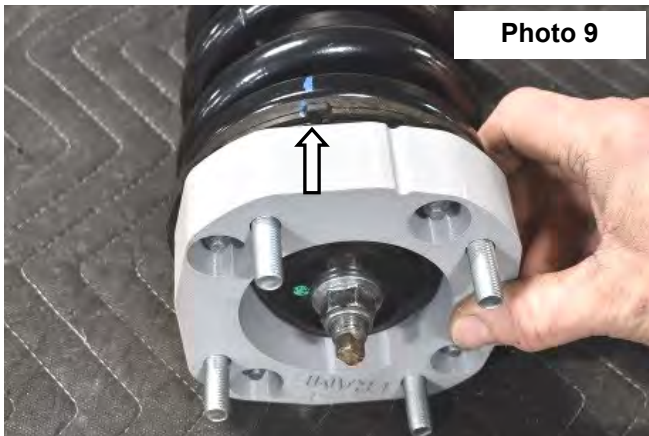

Photo 9

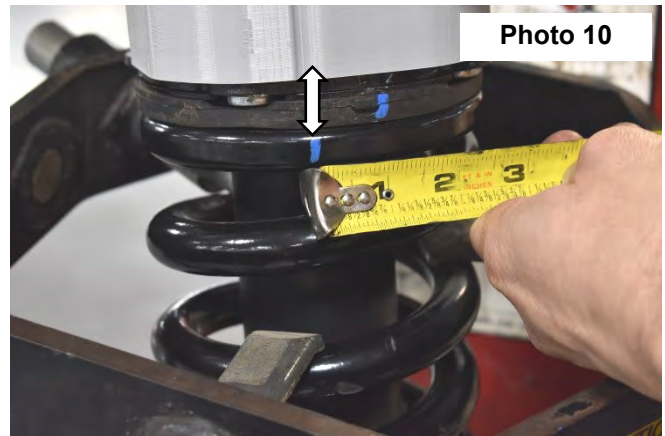

Photo 10

16. Install the strut assembly using the supplied 10mm flange lock nuts on the upper mounts and the factory hardware on the lower mount. **See Photo 11.**
17. Torque the lower mount to factory specs using a 22mm socket and wrench.
18. Torque upper hardware to 42ft/lbs using a 17mm socket.
19. Install the upper ball joint into the knuckle using the factory hardware and tighten using a 19mm wrench.
20. Install the factory brake line bracket back on the knuckle using the factory hardware, torque to factory specs using a 12mm socket.
21. Tighten the lower control arm bolts using a 24mm wrench.
22. Install the sway links on the lower control arms using the factory hardware, torque to factory specs using a 19mm socket.
23. Install the ABS wire bracket on the upper control arm using the factory hardware. Torque to factory specs using a 10mm socket.
24. Install the wheels and tires and lower the vehicle to the ground.
25. Using a certified alignment professional, have the vehicle aligned to factory specifications.

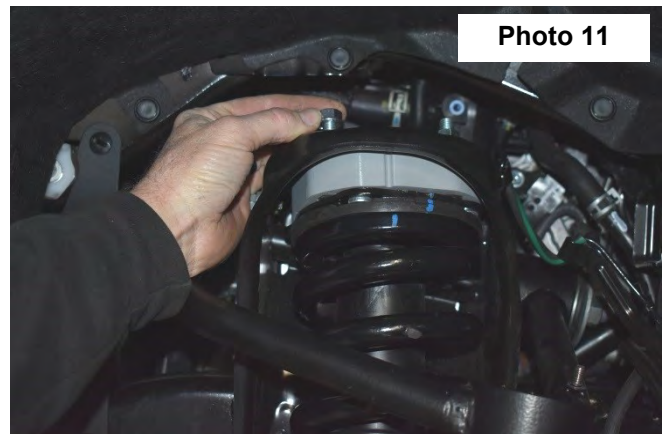

Photo 11

POST INSTALLATION

1. Check and recheck all fasteners for proper torque. Check to ensure there is adequate clearance between all rotating, mobile, fixed and heated members. Check clearance between upper control arm and sidewall of tire for proper clearance. Check steering for interference and proper working order. Test brake system.
2. Have an alignment performed by a certified alignment professional, to the factory specifications.
3. Perform steering sweep. Cycle the steering from full turn to full turn to check for clearance. Failure to perform inspections may result in component failure.
4. Re torque all fasteners after 500 miles. Visually inspect components and re torque fasteners during routine vehicle service.
5. Adjust headlights to proper settings given increased vehicle height.

MAINTENANCE INFORMATION

It is the ultimate buyers responsibility to have all bolts/nuts checked for tightness after the first 500 miles and then every 1000 miles. Wheel alignment steering system, suspension and driveline systems must be inspected by a qualified professional mechanic at least every 3000 miles.

KIT CONTENT:



Thank you for purchasing a Rough Country Suspension System.

By purchasing any item sold by Rough Country, LLC, the buyer expressly warrants that he/she is in compliance with all applicable , State, and Local laws and regulations regarding the purchase, ownership, and use of the item. It shall be the buyers responsibility to comply with all Federal, State and Local laws governing the sales of any items listed, illustrated or sold. The buyer expressly agrees to indemnify and hold harmless Rough Country, LLC for all claims resulting directly or indirectly from the purchase, ownership, or use of the items.

