

ROUGH COUNTRY
SUSPENSION SYSTEMS®



70894BAG

14-18 Subaru Forester Modular Roof Rack

Thank you for choosing Rough Country for all of your suspension needs.

Rough Country recommends that a certified technician install this system. In addition to these instructions, professional knowledge of disassemble/reassembly procedures as well as post installation checks must be known. Attempts to install this system without this knowledge and expertise may jeopardize the integrity and/or operating safety of the vehicle. Please read all the instructions before beginning the installation. Check the kit hardware against the "Kit Contents" list below. If question exist, please call us @1-800-222-7023. We will be happy to answer any questions concerning this product. Check all fasteners for proper torque. Check to ensure for adequate clearance between all components. Check and retighten wheels at 50 miles and again at 500 miles. Periodically check all hardware for tightness. Be sure you have all the needed parts and understand where they go. Also, please review the "Tools Needed" list to be certain you have the necessary tools to complete the installation.

PRODUCT USE INFORMATION

⚠ WARNING As a general rule, the taller a vehicle is the easier it will roll. We strongly recommend that seat belts and shoulder harnesses be worn at all times. Braking performance and capabilities are decreased when significantly larger/heavier tires and wheels are used. Do not add, alter, or fabricate any factory or after-market parts which increase vehicle height over the intended height of the Rough Country product purchased. Rough Country makes no claims regarding lifting devices and excludes any and all implied claims. We will not be responsible for any product that is altered.

NOTICE TO DEALER AND VEHICLE OWNER

⚠ NOTICE Any vehicle equipped with any Rough country product must have the "Warning to Driver" decal installed on the sun visor or dash. The decal is to act as a constant reminder for whoever is operating the vehicle of its unique handling characteristics. INSTALLING DEALER—It is your responsibility to install the warning decal and to forward these installation instructions on too the vehicle owner for review and to be kept in the vehicle for its service life.



14-18 Subaru Forester Modular Roof Rack

TOOLS NEEDED:

Anti-seize
Side Cutters
Wire Strippers
Wire Crimpers
Metric Wrench/Socket
5mm Allen Wrench
13mm Wrench

KIT CONTENTS:

Front Panel (1)
Rear Panel (1)
Driver Front Side Rail (1)
Pass Front Side Rail (1)
Driver Rear Side Rail (1)
Pass Rear Side Rail (1)
Driver Cross Rail Support (5)
Pass Cross Rail Support (5)
Driver Front / Rear Mount (2)
Pass Front / Rear Mount (2)
Driver Front Panel Mount (1)
Pass Front Panel Mount (1)
Bolt Plate (2)
Driver Front Light Bar Mount (1)
Pass Front Light Bar Mount (1)
Driver Rear Light Bar Mount (2)
Pass Rear Light Bar Mount (2)
Tent Mount (4)
Cube Light Mount (4)

HARDWARE INCLUDED:

8mm x 60mm Allen Bolt (36)
8mm x 20mm Allen Bolt (100)
8mm Flange Nut (38)
8mm Flat Washer (136)
M8 Fender Washer (4)
Long Nut Plate (2)
Medium Nut Plate (2)
Short Nut Plate (22)
Rubber Trim

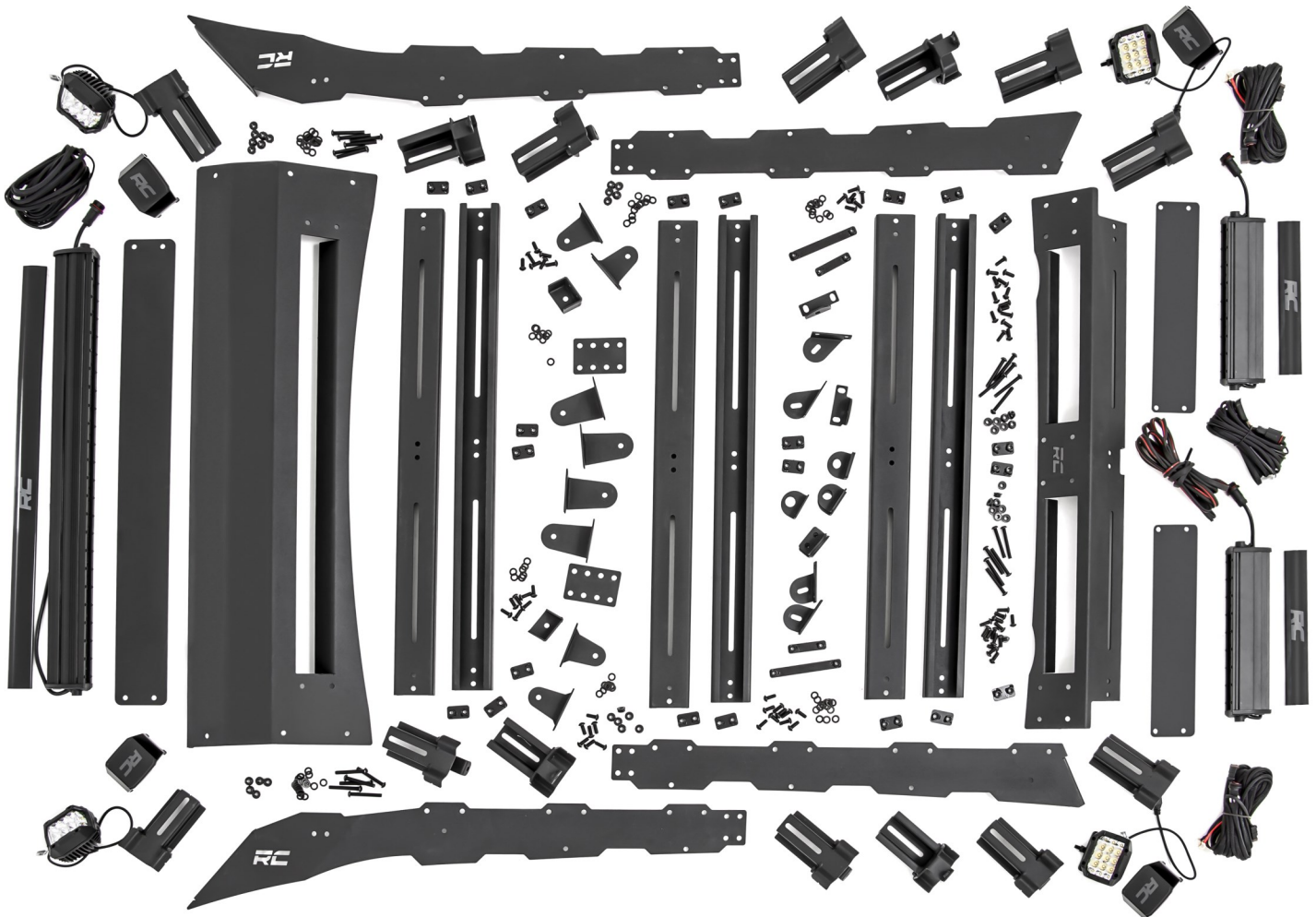

Roof Rack Installation

1. Start by laying all of your parts out and verifying that you have everything needed. You will only use a washer on the bolt head side for the entire rack build when assembling. Use **anti-seize** on all the hardware as you assemble the rack. The bolts are stainless to avoid rust, but being stainless they are prone to locking up over time or if over torqued. Leave all hardware **loose** until told to tighten. Torque all hardware to 5 ft-lbs when told. This rack is designed as a pressure fit onto the factory rails and if tightened down to early can cause fitment issues. There are side specific items in the rack and you will want to separate these parts. Pay close attention to the end of the front/rear mounts (x2) and cross rail supports (x5) as they have indicator notches. Gather these up and set them off to the side. These are the passenger side parts. **Photo 1 / 2**

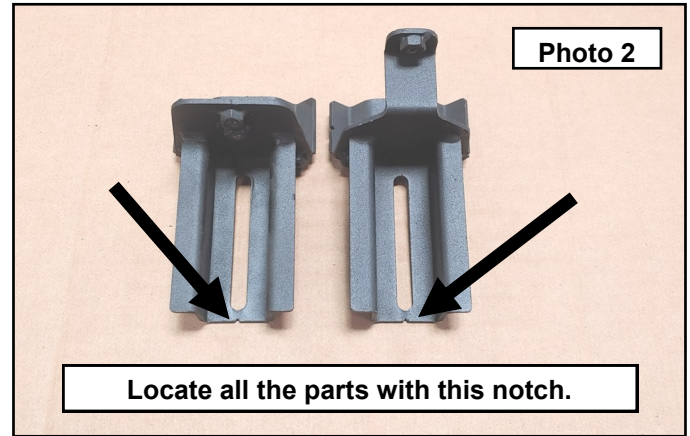
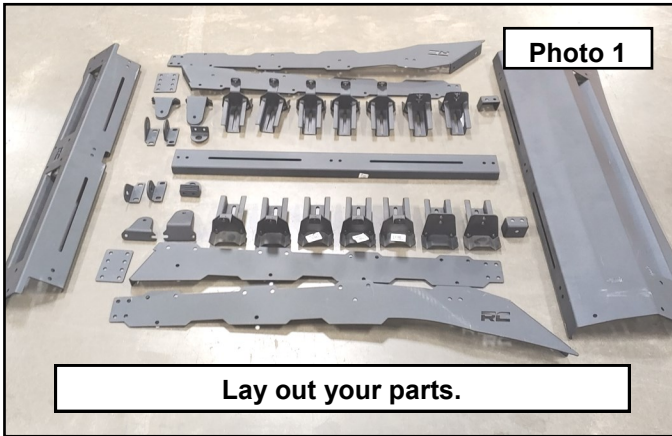

2. **Non lighting optioned rack:** Install the block off plates to the front and rear panels. The mounting holes in the panels are closer to one of the long side edges than the other. When installed, the holes closest to the edge will be the bottom of the panel. Install the block off panels to the front and back panel as shown using the provided 8mm button head bolts, washers, and flange nuts using a 5mm Allen and 13mm wrenches. **Photo 3 / 4**

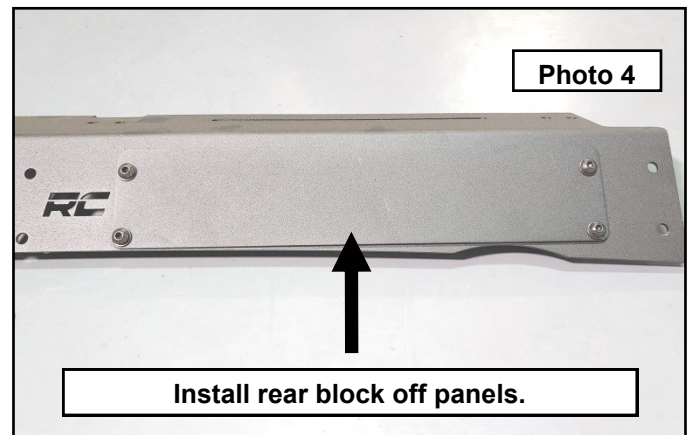
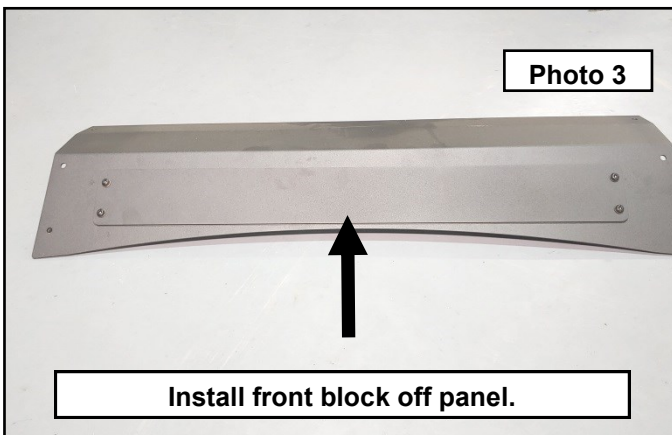

3. **Lighting optioned racks:** Locate the front light mounts and hardware from the rack kit. There will be 1 pair of light mounts that are different from the others, **you will see an angle near the bottom hole**. Install the light bar mounts to the front panel using the roof rack kit hardware 8mm x 20mm Allen bolts, washers, and flange nuts. Leave loose. Attach the light bar to the mounts as shown using the hardware and the spacers provided with the light bar. Leave loose. Once are all started, snug the light bar mounts up while aiming the light through the panel opening. Center the light and tighten all the hardware using a 5mm Allen and 13mm wrenches. **Photo 5 / 6**

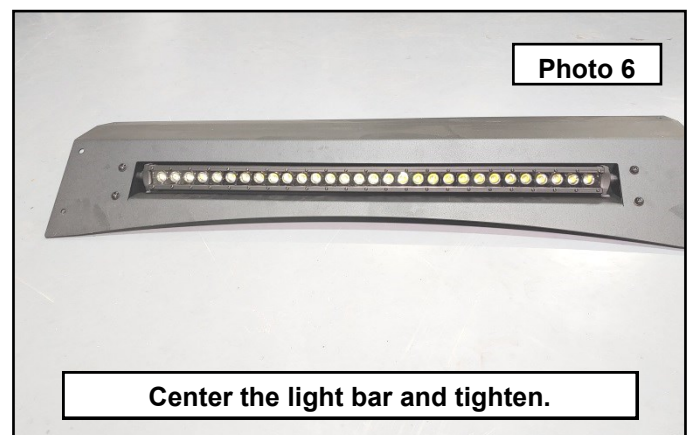
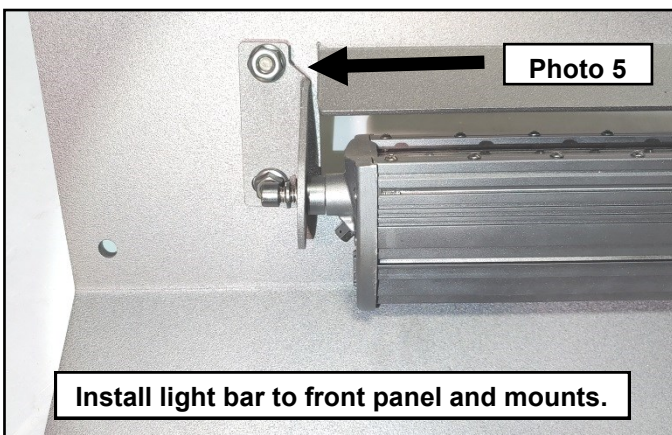

4. Locate the two panel mounts. Mount as shown using 8mm x 20mm button head bolt, washer and flange nut. Only snug these up. Pay attention to the angle of the brackets as they will line up with the bend lines when installed properly. They are driver and passenger side specific. **Photo 7**
5. When the panel mounts are installed correctly, they will line up with the driver and passenger front side rail. Install the front rails to the front panel using 8mm button head bolts, washers, and Long Nut Plate. Install the front rail to the panel mounts using 8mm button head bolts, washers and flange nuts. **Very IMPORTANT:** leave all hardware loose at this time. **Photo 8**

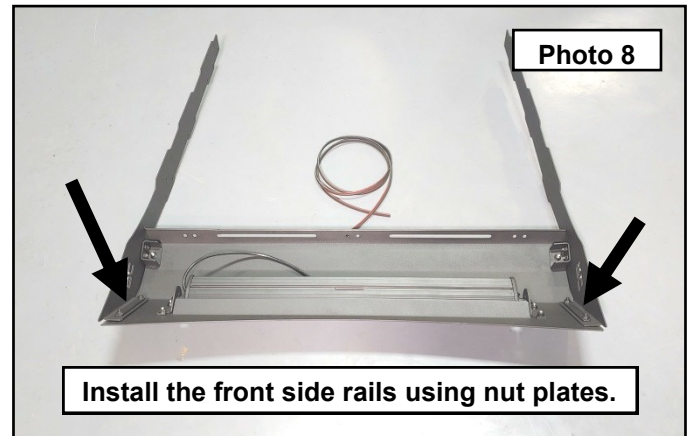
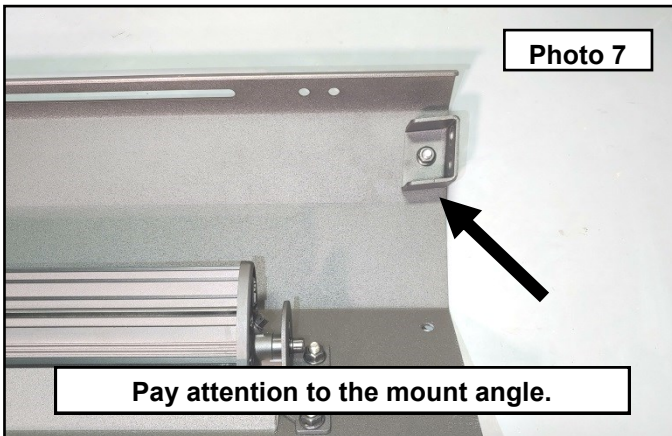

6. Install the rubber molding. Start by removing about an inch of the red tape from the inside of the rubber trim. Install the trim with the double sided tape on the back of the panels. Work the molding down until the material edge rests in the corner of the trim. As you work this down the edge of the parts, every couple of inches pull the tape out from behind. Firmly press on the back of the trim as you go to insure the tape is sticking. Complete this for the entire front panel edge. Once you get to the end, use a suitable cutting tool to trim the molding to length. **Photo 9 / 10**

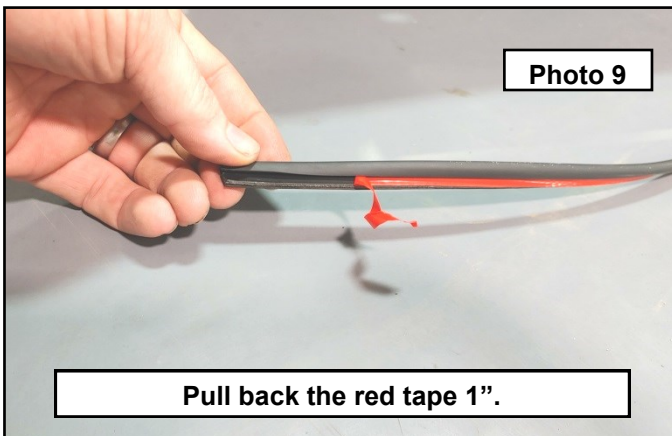

7. Repeat this process for the raised lips down the side rails. You will only put the rubber trim on the edges where the rack will make contact with the roof. The front piece you will stop at the bend line. **DO NOT** install past the bend line. The locations with mounting holes, you will need to leave a 1" gap as shown for bolt head and bracket clearances. **Photo 11 / 12**

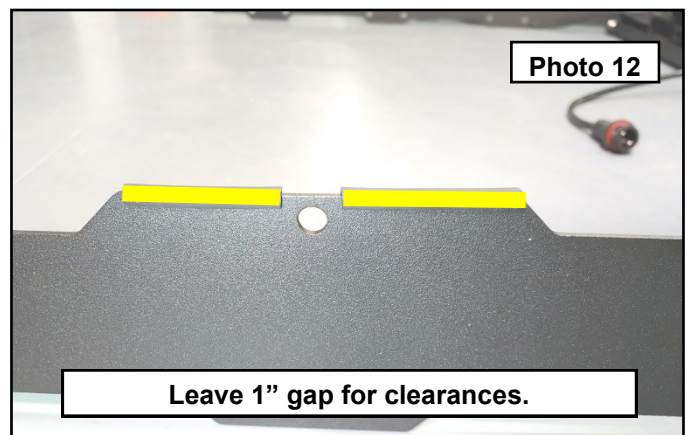
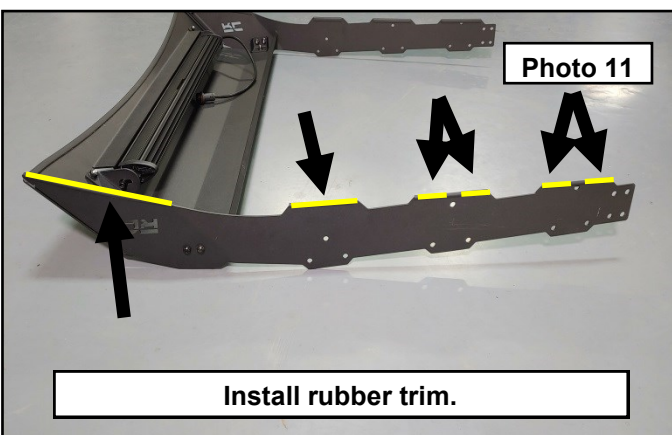

8. Install the lights to the remaining light brackets using the hardware from the light kits. Leave loose. Install the assembled lights and brackets to the rear panel using 8mm x 20mm button head bolts, washers and flange nuts. Center and aim the lights and then tighten down everything using 5mm Allen and 13mm wrenches. **Photo 13 / 14**

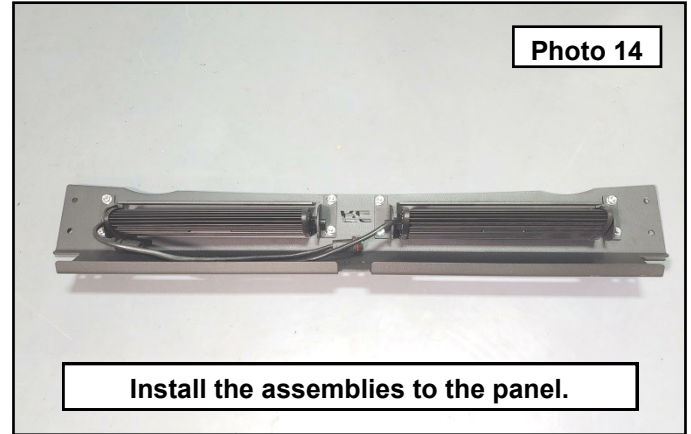
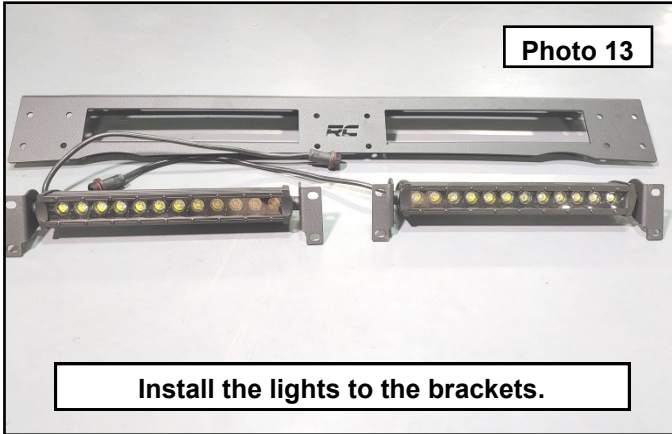

9. Locate a driver and passenger side front/rear mounts. You will have laid these parts out in step 1 to separate them. You will use one of each of these for the panel installation. Install the brackets to the rear panel using 8mm x 20mm button head bolts, washers and small nut tabs (Driver Side Shown Photo 15). **LEAVE LOOSE**. Notice the notch in the edge of the bracket. All of the mounts will have this notch. This indicates the rear of the vehicle and must be installed as shown (Passenger Side Shown Photo 16). **Photo 15 / 16**

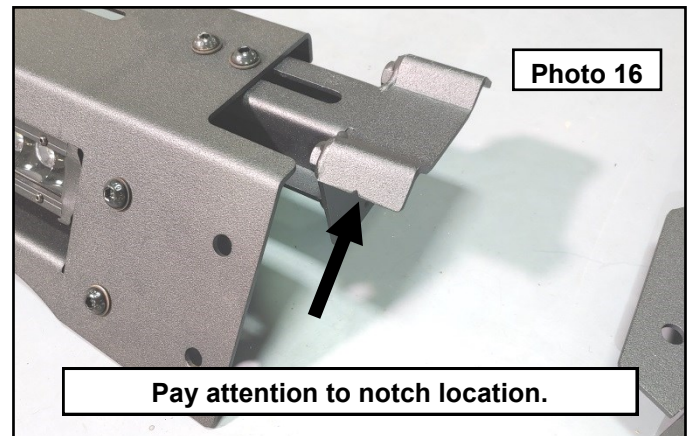
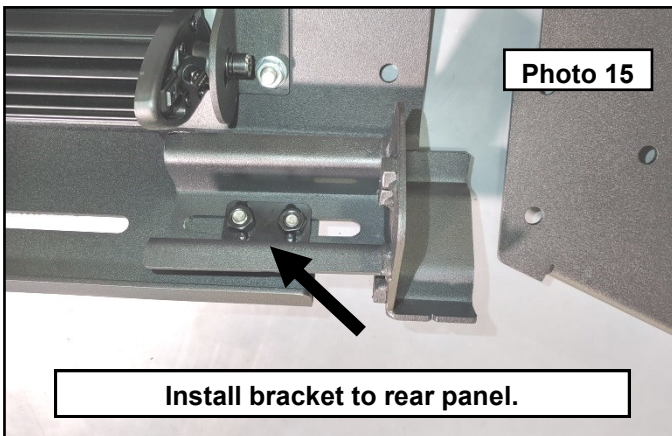

10. The roof is angled slightly wider at the front and the parts are all angled to match this. Photo 17 shows this angle when the parts are assembled. **Photo 17**
11. Attach the driver and passenger rear side rails to the rear mount brackets using the 8mm x 60mm button head bolts and washers. **LEAVE LOOSE**. **Photo 18**

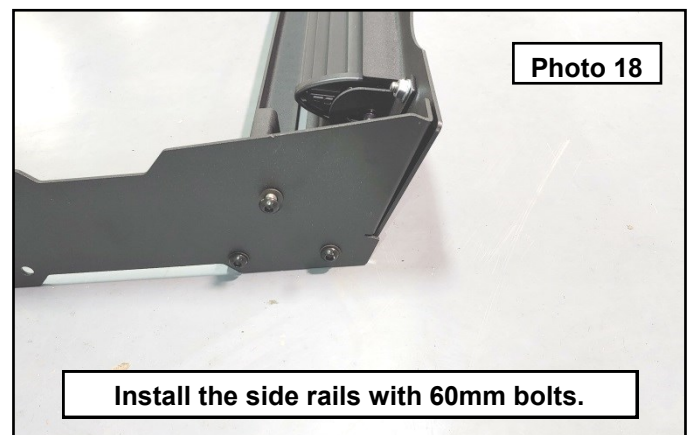
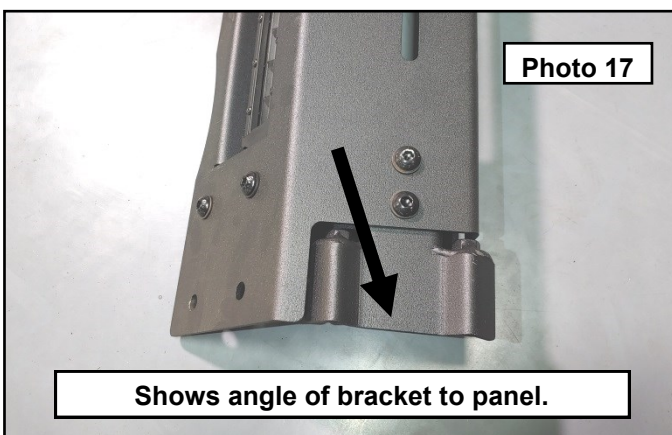

12. Install the rear panel to the side panels using the 8mm button head bolts, washers and Medium Nut Plates. **LEAVE LOOSE. Photo 19**
13. Install the rubber trim to the back panel and side panels as you did with the front half of the rack. **Photo 20**

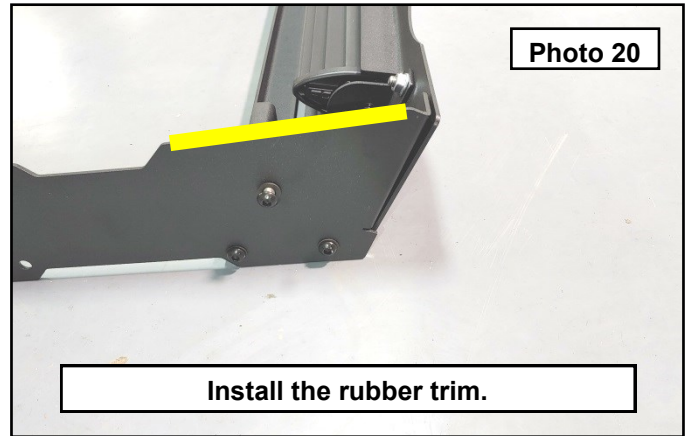
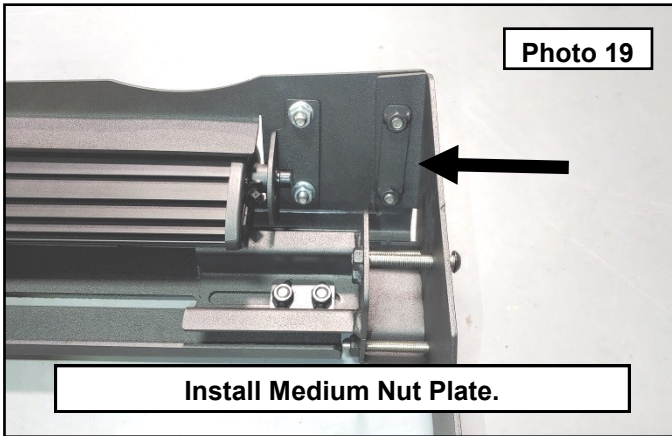

14. With the front and rear sections assembled, you will need a helper to position the rack ends. Set the front half onto the vehicle. The side rails will be a tight fit around the factory rails. This is the reason for leaving everything loose. The material is flexible and will fit with everything in place once done. When placing the front half on, you will see the cut out in the side rail allows the factory roof rail to be seen. Position the front half so that the bend line behind the RC logo is just even with the factory rail. **Photo 21 / 22**

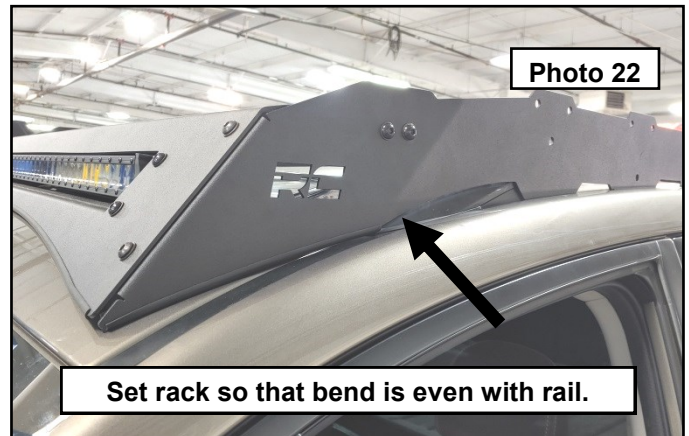
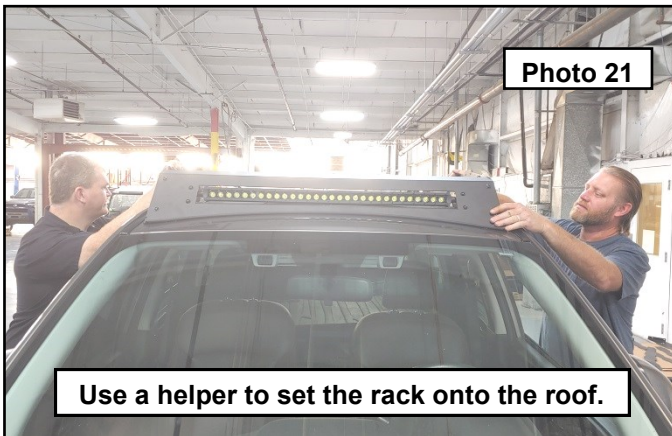

15. Set the back half onto the roof. Once you have the two side rails lined up, attach the bolt plates using the 8mm button head bolts, washers and flange nuts. The bottom row of hardware will end up below the factory rails. Once you get these snugged up, install the upper hardware. The nuts are self locking and only require you to snug them in place to start the lock so where it is tight under the factory rail to get a wrench you can just hold the nut from spinning to the point that it catches. Leave the hardware loose at this time though. **Photo 23 / 24**

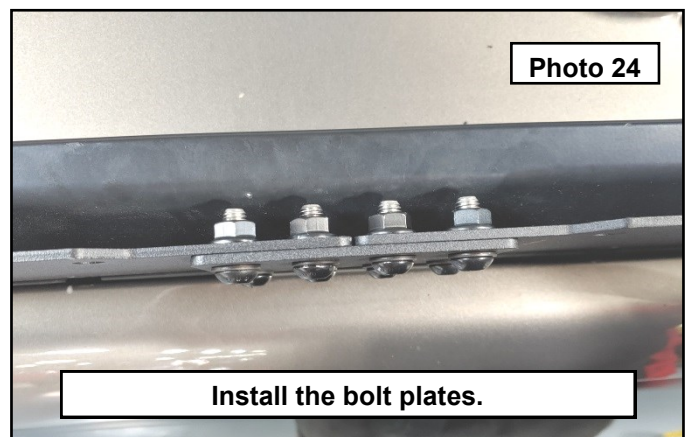
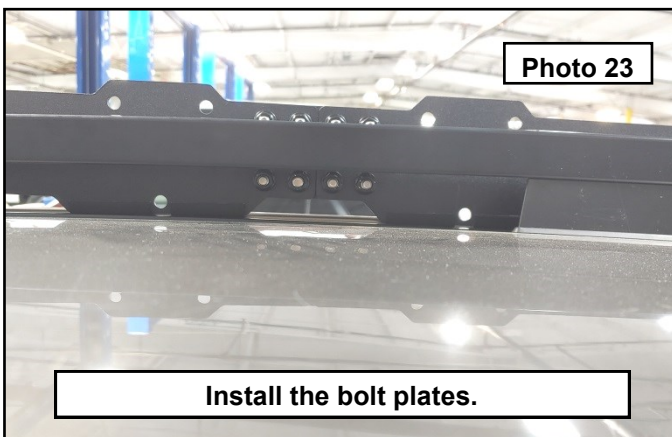

16. Your rack should look like this at this time with front and rear panel bolted to the side rails, and the bolt plates installed. All mounting hardware should still be loose. **Photo 25 / 26**

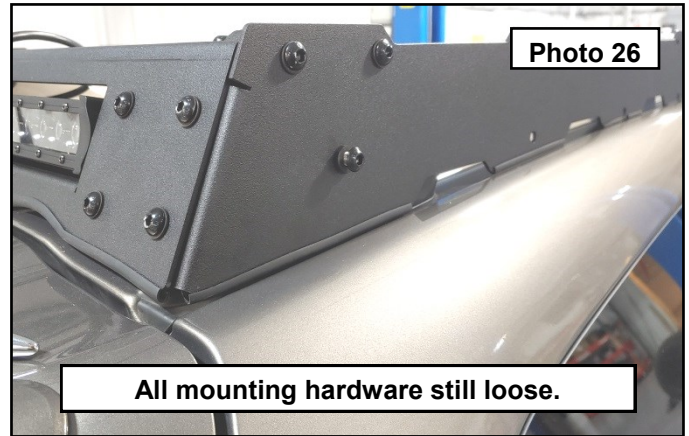
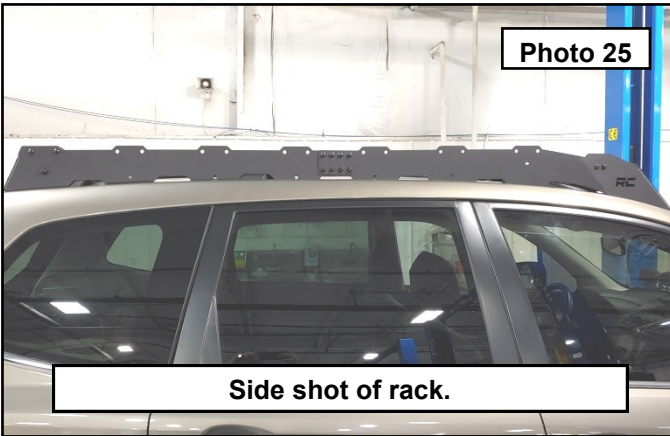

17. Locate the cross rail supports that you separated in the first steps. There are 5 driver and 5 passenger mounts. These all have the indicator notch that will face the back of the rack just like the rear panel installation. The passenger side mounts also have a notch on the end of the part. These mounts are made to clamp around the factory rails. Install them to the side rails using the 8mm button head bolts and washers in the lower hole (start all these first) and the 8mm x 60mm button head bolts and washers to the top holes. **LEAVE LOOSE. Photo 27 / 28**

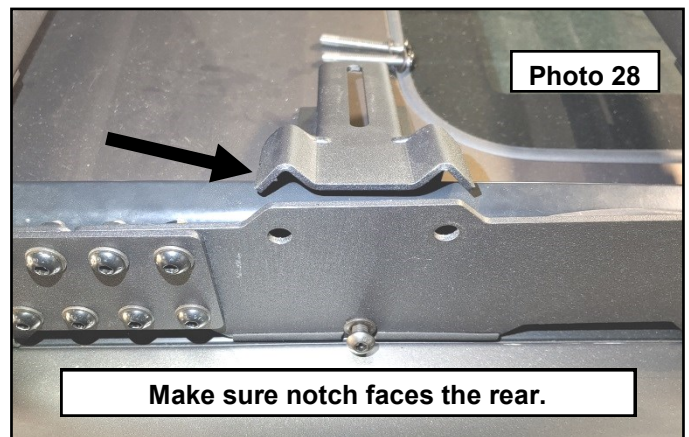
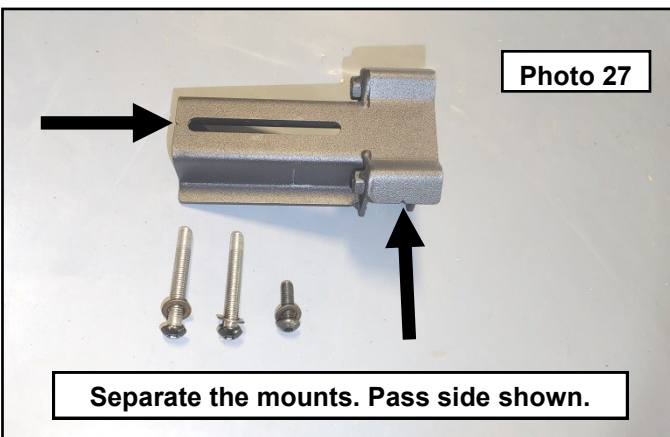

18. With all of the driver and passenger side mounts are in place, install the front mounts in the same manner using 8mm x 60mm button head bolts and washers at all 3 locations. All of the cross rail supports will act as clamps around the factory rails. **LEAVE LOOSE.** Install the cross rails to the supports as shown. You will want to lay all of the rails in place. The cross rails are universal. You will notice that as you lay them in place the gaps from the sides increase more going towards the front. You will center the cross rails in the next step. Install the cross rails using the Small Nut Plate under the mounts and the 8mm button head bolts and washers. **LEAVE LOOSE.** Once all are started, go around and tighten all of the hardware on the side rails. Torque to 5 ft-lbs. **Photo 29 / 30**

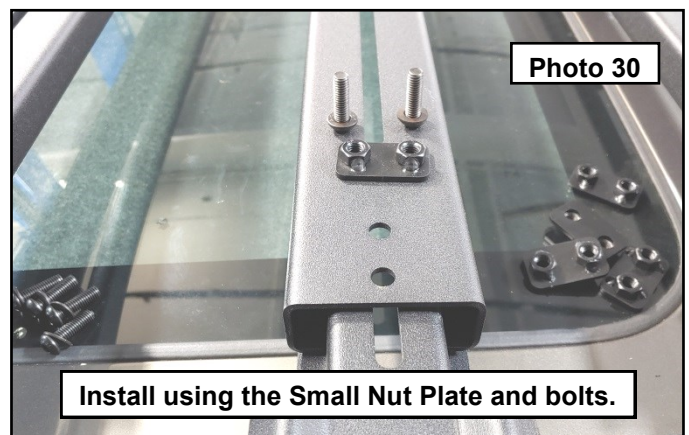

19. Attach one of the tie downs to the front panel middle mounting holes using the 8mm button head bolts, washers and small nut tab. Tighten down. Hook a ratchet strap to the tie down hole and pull all the way to the back of the rack. This will be your guide to center the cross rails. Once you have the strap in place, center the cross rails and torque the mounting hardware. You can leave the tie down there or move it to where it is needed. **Photo 31 / 32**

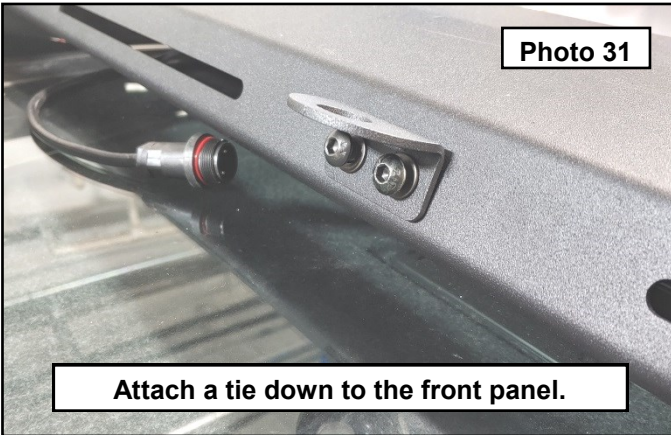

20. For the lighting optioned customers, if you bought the full expedition style kit with the side lights, you can install the side light mounts. The mounts are universal and can be mounted at any position down the side rails where there is a cross bar. Remove the top left bolt of any of the locations completely while backing the right one out partially. Slide the light mount onto the partially removed bolt and install the other. Torque to 5 ft-lbs. Install the cube lights with the bolt facing down as shown. **Photo 33 / 34**

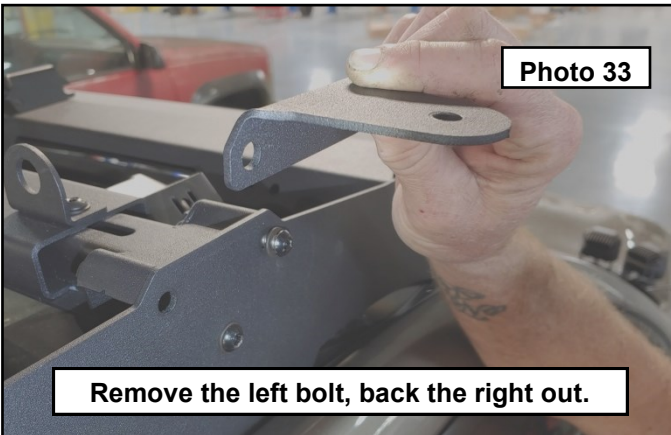

21. Run the extension harnesses to the lights and down the rails. Use the "tunnels" created by the cross rail mounts to keep the installation neat and tidy. It will be up to the installer to run the harnesses through or under the car. Shown in the picture is a possible route. After coming out of the hole at the back of the rear panel, the harnesses were run down the back pillar of the door and routed under the car to the engine bay. Zip ties are recommended every few inches to keep them bundled together. **Photo 35 / 36**

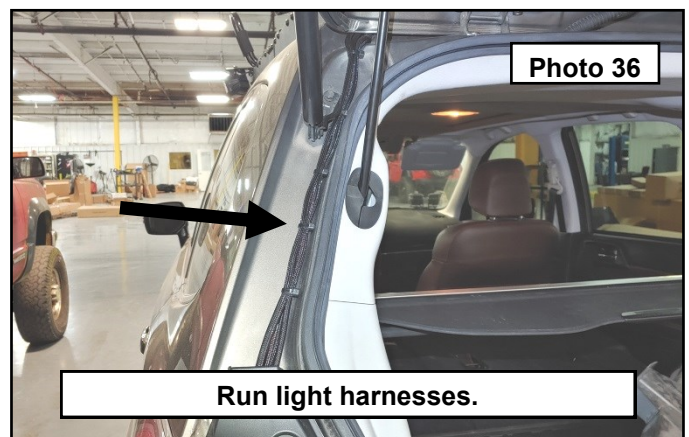
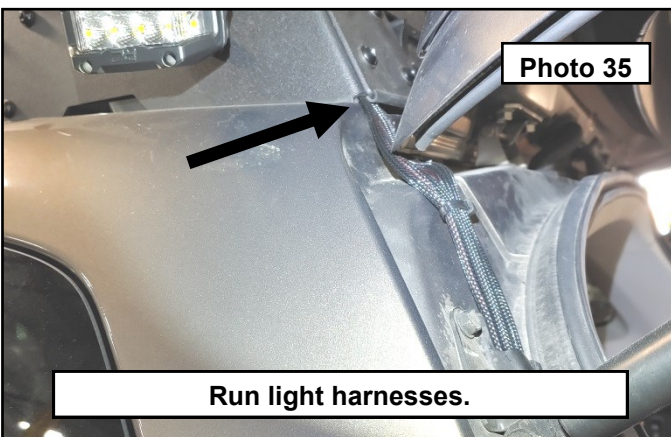

22. In this instance, the taillight was removed and the wires were tucked into the area behind the light. If you use this method, trim the light plastic to allow the harnesses to fit with the light installed. You can enter the vehicle's rear kick panel through the light harness grommet if you would like to run inside the car to the engine bay. If you use this route, make sure that the wires do not sit in front of the door bumper. Then run the wiring to the front of the car into the engine bay. Find an appropriate spot for your switches. Shown is a panel that was made to go onto the fuse panel door using 3/4" round rocker switches. The door was cut out to allow the switches to fit and the wires run. **Photo 37 / 38**

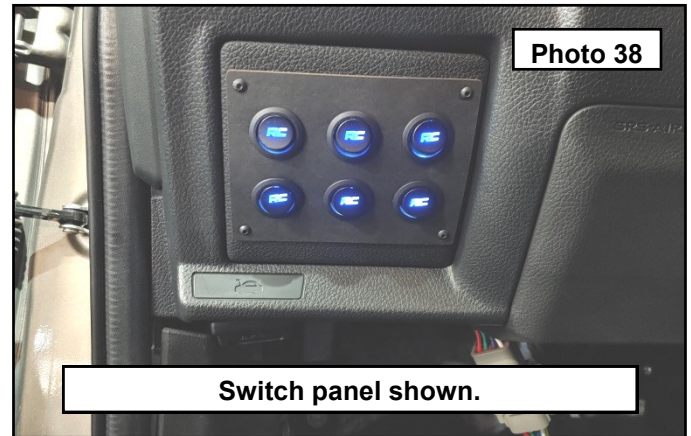
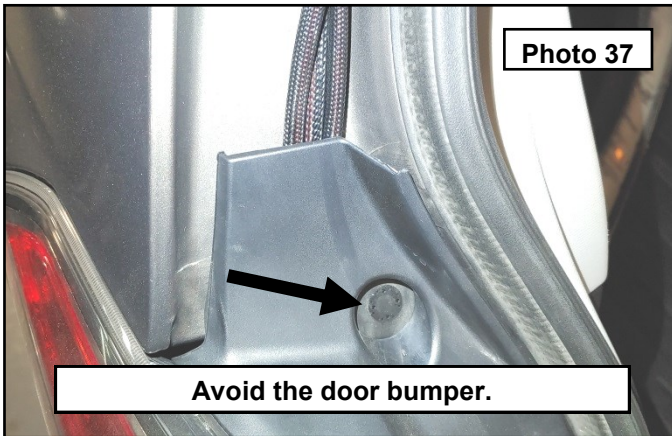

23. Included with the kit are 4 tent mount brackets and are designed around tents in sizes of 4' x 4' and 4' x 5'. These install the same way as the light brackets except facing onto the rack. With the tent mounts, you will want to install them as far to the front and rear as possible. If you have the light mounts installed at the first and last spots, then install the tent mounts on the next row. You will be required to drill 8mm holes into the floor of the tent to mount to use the mounts. Center your tent onto the rack. Mark and drill the mounting locations. Install the tent using the provided 8mm x 60mm button head bolts, fender washers, and flange nuts. Make sure these are tight but do not crush the tent floor. Periodically check the tightness of the hardware. **Photo 39 / 40**

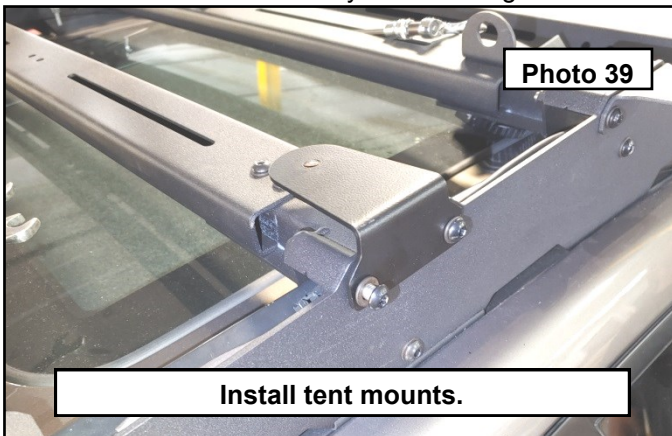

24. The provided tie downs are universal and can mount at any point on the rack rails you prefer or need them to be at. Use the nut tabs and extra 8mm hardware to mount along the slots or the 2 hole locations along the rack. They will also fit where the cross rails bolt in using the cross rail hardware. Universal Kayak mounts with Kayak, luggage and spare tire shown. **Photo 41 / 42**

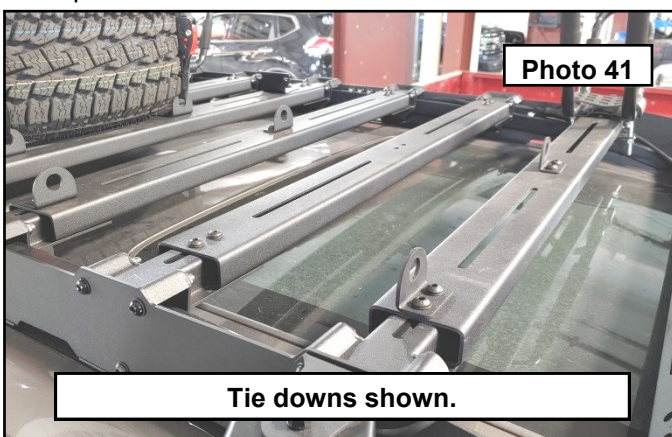



By purchasing any item sold by Rough Country, LLC, the buyer expressly warrants that he/she is in compliance with all applicable , State, and Local laws and regulations regarding the purchase, ownership, and use of the item. It shall be the buyers responsibility to comply with all Federal, State and Local laws governing the sales of any items listed, illustrated or sold. The buyer expressly agrees to indemnify and hold harmless Rough Country, LLC for all claims resulting directly or indirectly from the purchase, ownership, or use of the items.

