

# ROUGH COUNTRY

## SUSPENSION SYSTEMS®

### JEEP 2010-17 Patriot Rear Loaded Struts

Thank you for choosing Rough Country for all your vehicle needs.

Please read instructions before beginning installation. Check the kit hardware against the kit contents shown below. Be sure you have all needed parts and know where they go.

If question exist, please call us @1-800-222-7023. We will be happy to answer any questions concerning this product.

Check all fasteners for proper torque. Check to ensure for adequate clearance between all components.

Periodically check all hardware for tightness.

#### KIT CONTENTS:

Loaded Struts x2

#### TOOLS NEEDED:

Jack  
Jack Stands  
13mm Wrench or Socket  
15mm Wrench or Socket  
18mm Wrench or Socket

#### HARDWARE INCLUDED:

Upper Strut Nuts x4



#### Torque Specs:

Size	Grade 5	Grade 8	Size	Class 8.8	Class 10.9
5/16"	15 ft/lbs	20ft/lbs	6MM	5ft/lbs	9ft/lbs
3/8"	30 ft/lbs	35ft/lbs	8MM	18ft/lbs	23ft/lbs
7/16"	45 ft/lbs	60ft/lbs	10MM	32ft/lbs	45ft/lbs
1/2"	65 ft/lbs	90ft/lbs	12MM	55ft/lbs	75ft/lbs
9/16"	95 ft/lbs	130ft/lbs	14MM	85ft/lbs	120ft/lbs
5/8"	135ft/lbs	175ft/lbs	16MM	130ft/lbs	165ft/lbs
3/4"	185ft/lbs	280ft/lbs	18MM	170ft/lbs	240ft/lbs



## INSTALLATION INSTRUCTIONS

1. Lift the rear of the vehicle up using a floor jack. Place jack stands under the frame rail and lower.
2. Remove the rear wheels and tires from the vehicle.
3. Remove the rear floor panel from the vehicle. **See Photo 1.**
4. Remove the inner sound padding from each side of the upper strut mounts. **See Photo 2.**



5. Remove the brace as shown from both passenger and driver side using a 15mm wrench. **See Photo 3.**
6. Remove the sway bar link as shown using a 13mm wrench & socket. Retain bushings, cup washers and lower nut for reuse. **See Photo 4.**

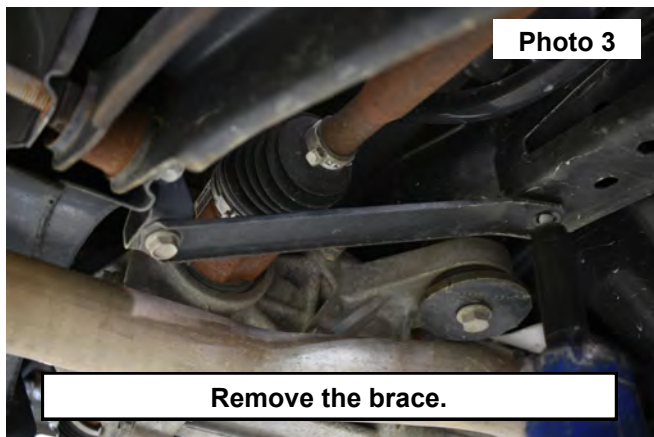

7. Support the inner lower control arm using a floor jack. Loosen the lower strut nut using a 18mm wrench and socket. **See Photo 5.**
8. Remove the inner frame mount control arm bolt using an 18mm socket and wrench. **See Photo 6.**

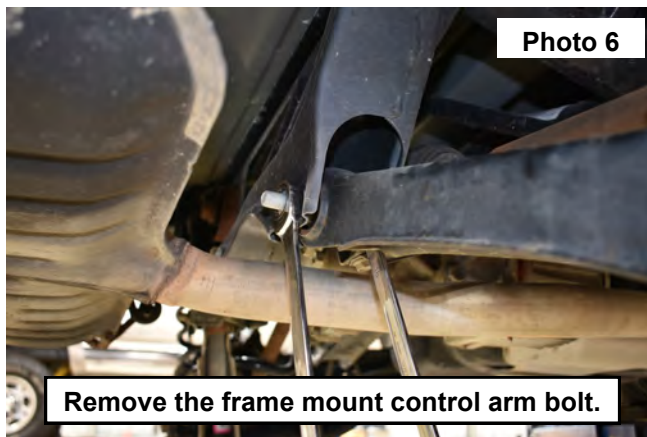
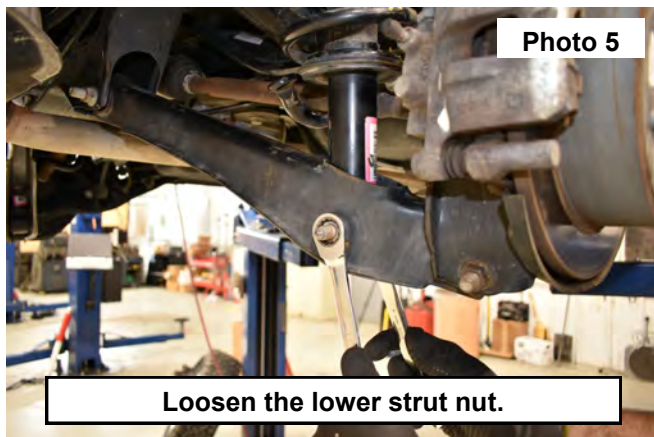

- Support the strut. Remove the (2) upper strut nuts using a 14mm wrench. **See Photo 7.**
- Install the new strut with the point side of the strut hat to the out side. Secure using (2) of the supplied 10mm flange lock nuts. **See Photo 8.**

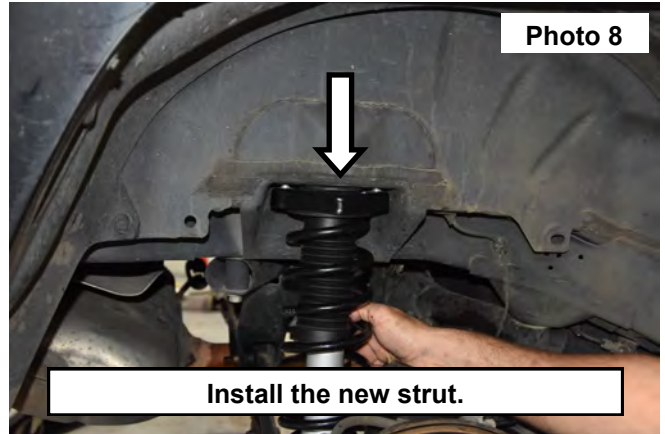
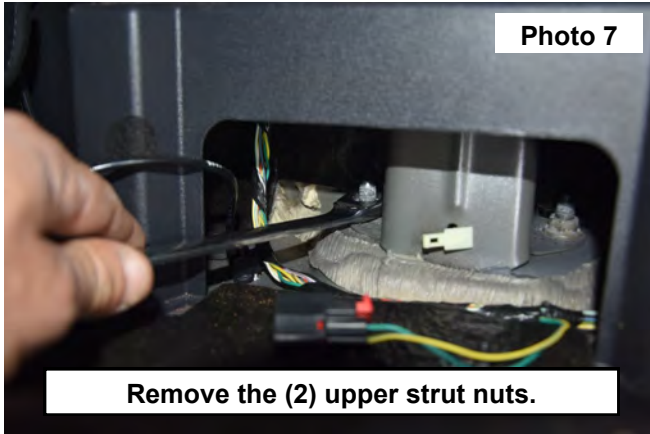

- Place the strut into the lower control arm using the retained OE bolt and nut. **See Photo 9.**
- Raise the control arm into the frame mount using a jack, and place the bolt into the control arm and mount. **See Photo 10.**

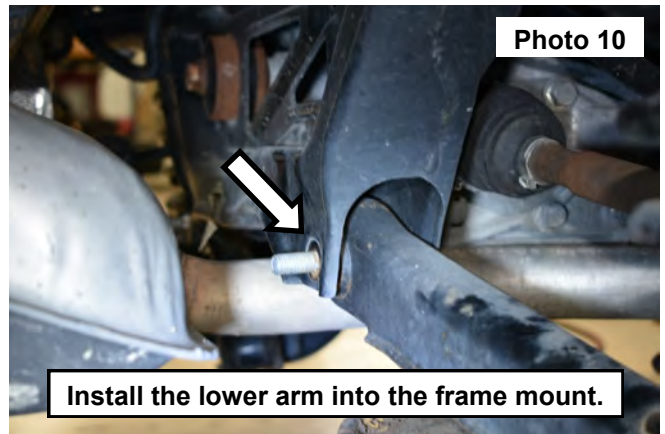
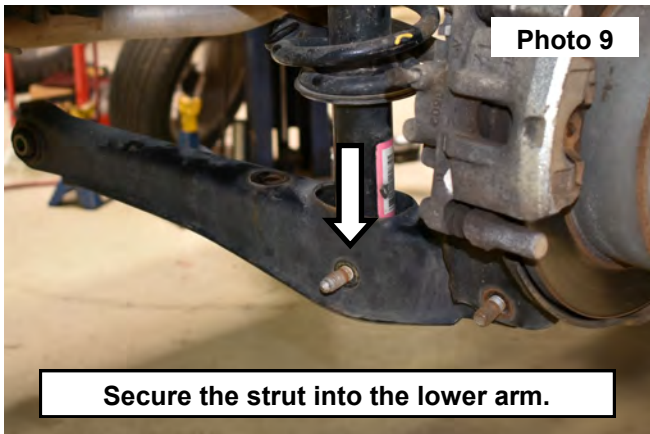

- Place the brace into the OE location using the retained hardware. Tighten using a 15mm socket. **See Photo 11.**
- Install the sway link and hardware. Tighten using an 13mm socket and wrench. **See Photo 12.**
- Repeat steps 1-14 on the opposite side of the vehicle.

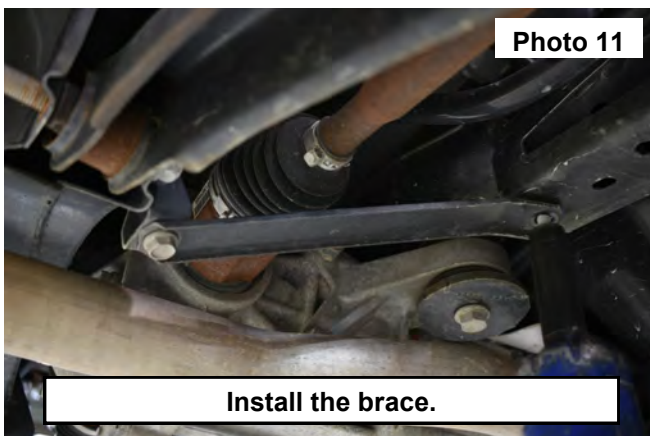

16. Install the wheels and tires.
17. Lift the vehicle up using a jack and remove the stands and lower onto the ground.
18. With the vehicle on the ground, tighten the lower strut and inner control arm mount using a 18mm socket and wrench. **See Photo 13.**
19. Install the inner sound padding on each side of the upper strut mounts. **See Photo 14.**

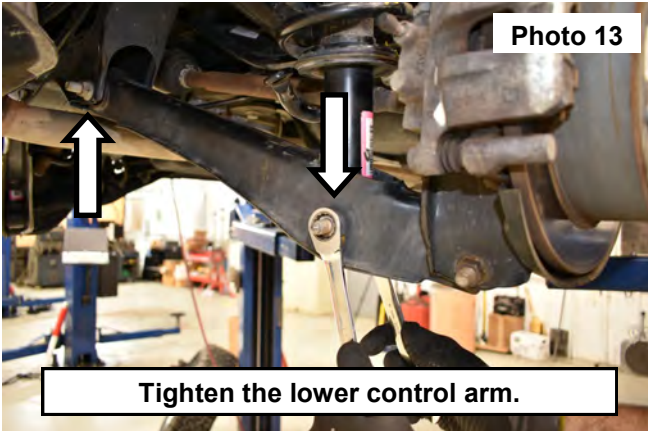

20. Install the rear floor panel into the vehicle. **See Photo 15.**



By purchasing any item sold by Rough Country, LLC, the buyer expressly warrants that he/she is in compliance with all applicable, State, and Local laws and regulations regarding the purchase, ownership, and use of the item. It shall be the buyers responsibility to comply with all Federal, State and Local laws governing the sales of any items listed, illustrated or sold. The buyer expressly agrees to indemnify and hold harmless Rough Country, LLC for all claims resulting directly or indirectly from the purchase, ownership, or use of the items.

