



600-56-0883

JEEP JL 2018 - 20XX

FRONT FLARE DELETE INSTALLATION INSTRUCTIONS



SAFETY

Know Safety, no injury. Know injury, no safety. ~Author Unknown

If there are any questions, call 1-855-HHTOUGH

- **READ ALL SAFETY INSTRUCTIONS BEFORE INSTALLATION**
 - FOLLOW ALL INSTRUCTIONS FOR PROPER ASSEMBLY
 - WEAR APPROPRIATE EYE PROTECTION
 - EXERCISE CARE WHEN LIFTING COMPONENTS
 - USE APPROPRIATE TORQUE FOR BOLTS
 - BLUE THREAD LOCKING COMPOUND IS RECOMMENDED ON ALL BOLTS

SUGGESTED TORQUE VALUES FOR STEEL GRADE SAE 5 BOLTS

BOLT DIAMETER (INCH)	TREADS PER INCH	TORQUE (POUND-FEET)
1/4	20	7
5/16	18	14
3/8	16	25
7/16	14	40
1/2	13	60
9/16	12	88
5/8	11	120
3/4	10	200
7/8	9	302
1	8	466



600-56-0883

I. PARTS LIST

ITEM NO.	QTY	PART NUMBER	DESCRIPTION
1	1	601-56-5127	LEFT FRONT FLARE DELETE
2	1	601-56-5128	RIGHT FRONT FLARE DELETE
3	1	60K-56-0183	HARDWARE KIT #183

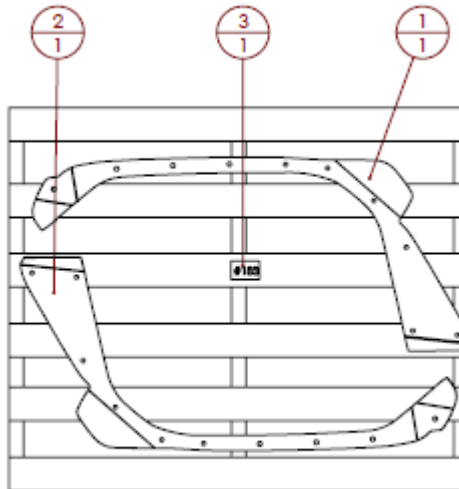

REMOVE CONTENTS FROM BOX AND VERIFY ALL PARTS ARE PRESENT.

If there are any questions, call 1-855 HHTOUGH or email HHORDERS@hammerheadarmor.com

II. TOOL LIST

1. A Good Friend
2. Basic Tool Kit
3. Torx 40 socket
4. 13mm wrench
5. Vice grips

III. VEHICLE PREPARATION

1. Park vehicle on level surface and engage parking brake.
2. Using the 10mm socket, remove the 6 bolts in the inner fender of your front flare.
3. Pull the front flare outward and away from the body of the Jeep to remove it. It is designed with plastic clips that will detach when pulled. The plug for the lights is located behind the flare. **BE SURE TO UNPLUG THE HARNESS BEFORE THE FLARE IS PULLED TOO FAR FROM THE VEHICLE.**

4. You will need to REMOVE the 4 braces shown below in order to install the Flare Delete. We recommend using a grinder and a cutting wheel. (MAKE SURE TO WEAR PROPER PROTECTIVE GEAR)

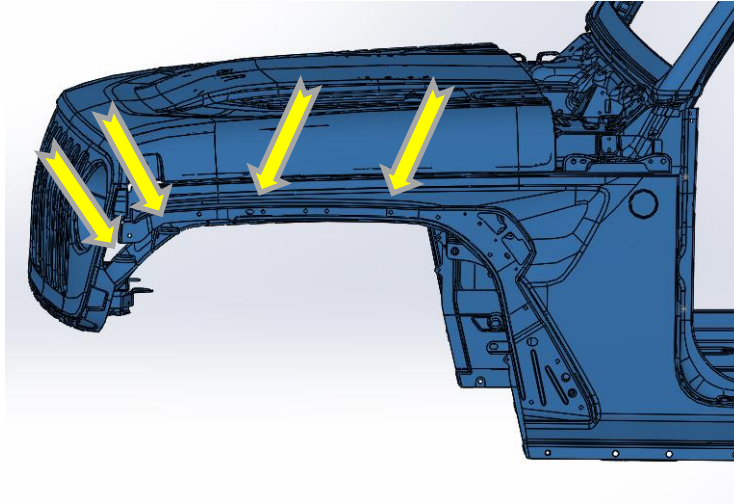

5. Do this for both sides.

IV. FLARE DELETE INSTALLATION

1. The Flare Delete installs with 2 different spacers and bolt lengths. The 5/16" spacers and the 3/4" length bolts are located as shown below.

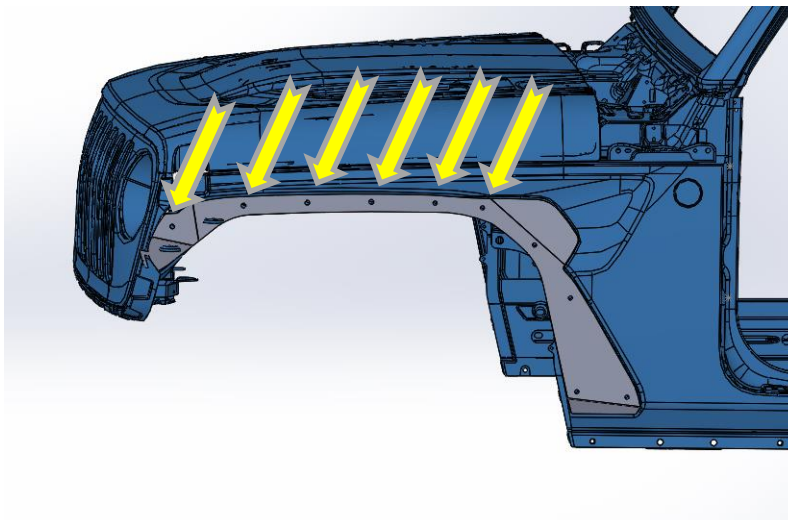



600-56-0883

2. The ½” spacers and the 1” length bolts are located as shown below.

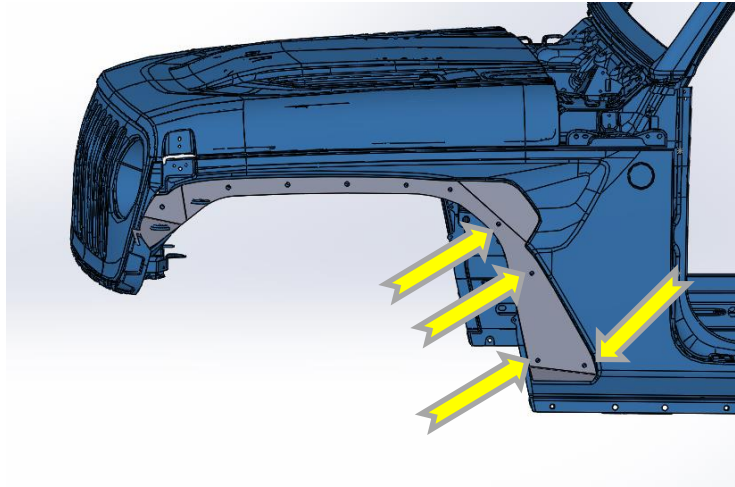

3. Using the torx 40 and the 13mm install the flare with the correct bolts and spacers per instructions 1 and 2, as well as washers and nylock nuts. (bolt, Flare Delete, spacer, Jeep fender, washer, nylock nut)
4. In order to get the nuts started, use a set of vice grips to secure the nut. Then use the 13mm wrench to finish tightening.
5. The Flare Delete has slight adjustment. Adjust until it is not touching the Fender of the Jeep in any locations.
6. Tighten all hardware to 14ft-lbs
7. Do this for both sides.

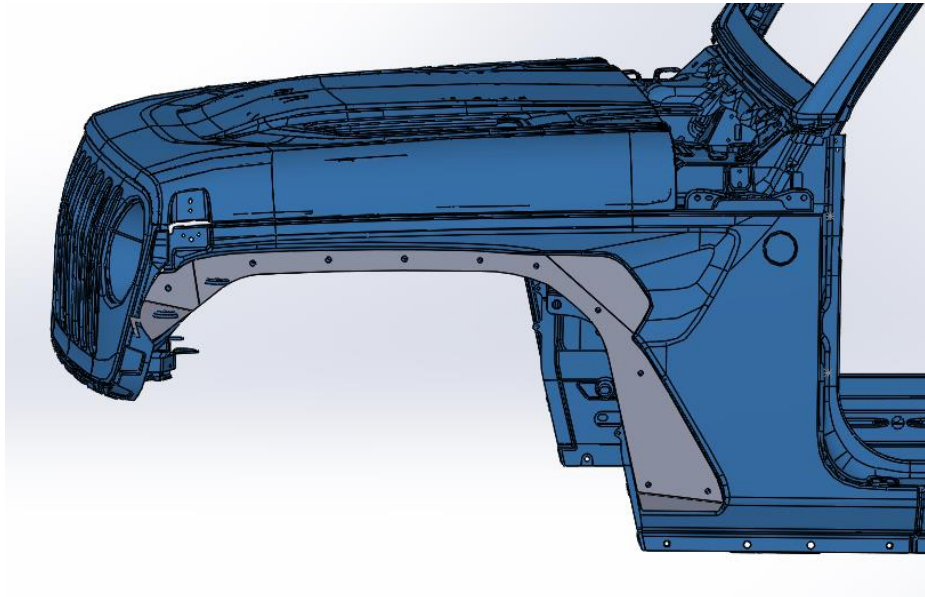

**Congratulations! Your Installation is now complete.
Thank You for your purchase!**