

2011-2016 FORD F-250

BULL BAR INSTALLATION INSTRUCTIONS



SAFETY

Know safety, no injury. Know injury, no safety. ~Author Unknown

If there are any questions, call 1-855-HHTOUGH

- **READ ALL SAFETY INSTRUCTIONS BEFORE INSTALLATION**
 - FOLLOW ALL INSTRUCTIONS FOR PROPER ASSEMBLY
 - WEAR APPROPRIATE EYE PROTECTION
 - EXERCISE CARE WHEN LIFTING COMPONENTS
 - USE APPROPRIATE TORQUE FOR BOLTS

SUGGESTED TORQUE VALUES FOR STEEL GRADE SAE 5 BOLTS

BOLT DIAMETER (INCH)	TREADS PER INCH	TORQUE (POUND-FEET)
1/4	20	7
5/16	18	14
3/8	16	25
7/16	14	40
1/2	13	60
9/16	12	88
5/8	11	120
3/4	10	200
7/8	9	302
1	8	466

I. PARTS LIST

ITEM NO.	QTY	PART NUMBER	DESCRIPTION
1	1	600-56-0864	Standard Bullbar (All Lights)
1.1	1	60P-56-0864	600-56-0864 POLISHED
1.2	1	60K-56-0092	HARDWARE KIT #92 (B BAR MOUNT)
1.3	1	443-01-0086	LICENSE PLATE MOUNTING KIT
2	1	600-56-0878	BULL BAR MOUNT KIT
2.1	1	601-56-3953	RIGHT MOUNT WELDMENT
2.2	1	601-56-3956	LEFT MOUNT WELDMENT
2.3	1	601-56-4052	LEFT BRACE BRACKET
2.4	1	601-56-4053	RIGHT BRACE BRACKET
2.5	1	60K-56-0004	HARDWARE KIT #4

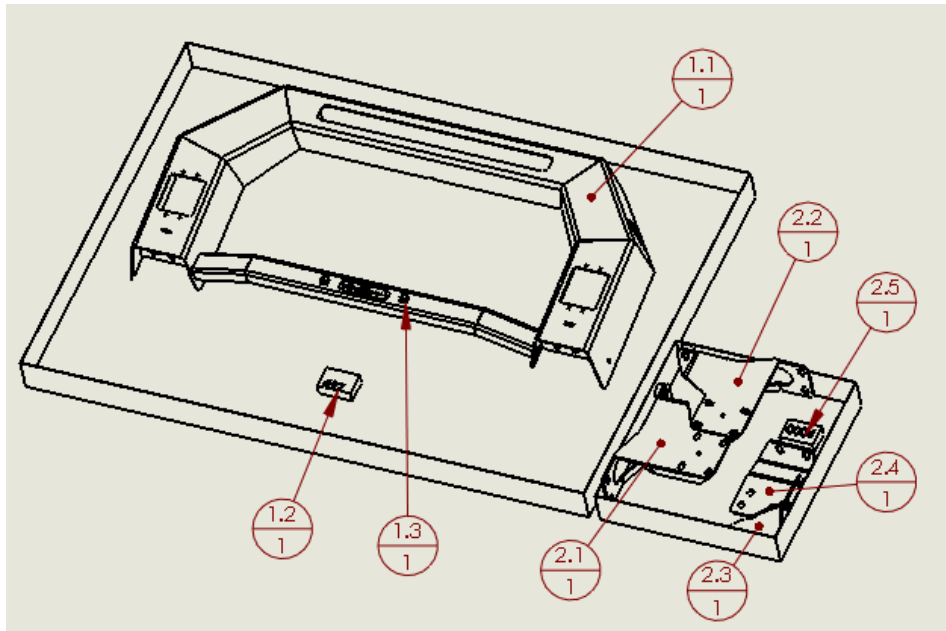

REMOVE CONTENTS FROM BOX AND VERIFY ALL PARTS ARE PRESENT.
If there are any questions, call 1-855-HHTOUGH or email
HHORDERS@hammerheadarmor.com

II. TOOL LIST

1. Basic tool set
2. 18mm socket
3. 9/16" socket
4. 3" extension

III. PREPARE BULL BAR FOR INSTALLATION

1. Install lights with provided hardware at this time.
2. Install license plate mounting kit if desired.

IV. INSTALL BULL BAR

1. Locate 2 bolts beside the passenger side tow hook on the front of the bumper.



2. Using an 18mm socket, remove the 2 bolts. Be careful not to lose the backing plate located behind the bumper.

NOTE: The bumper may move down when these 2 bolts are removed.



Backing Plate

3. Using the OE hardware, install the frame mount around the tow hooks and tighten both bolts.

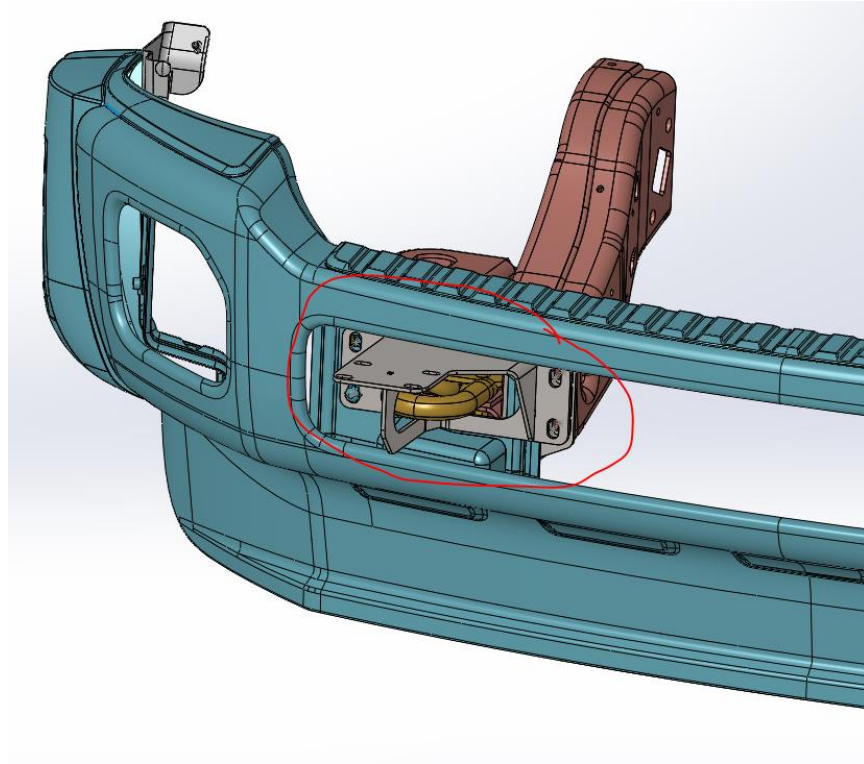

4. The brace bracket will mount from the side of the frame horn to the back of the bull bar mount. (See Pic below)

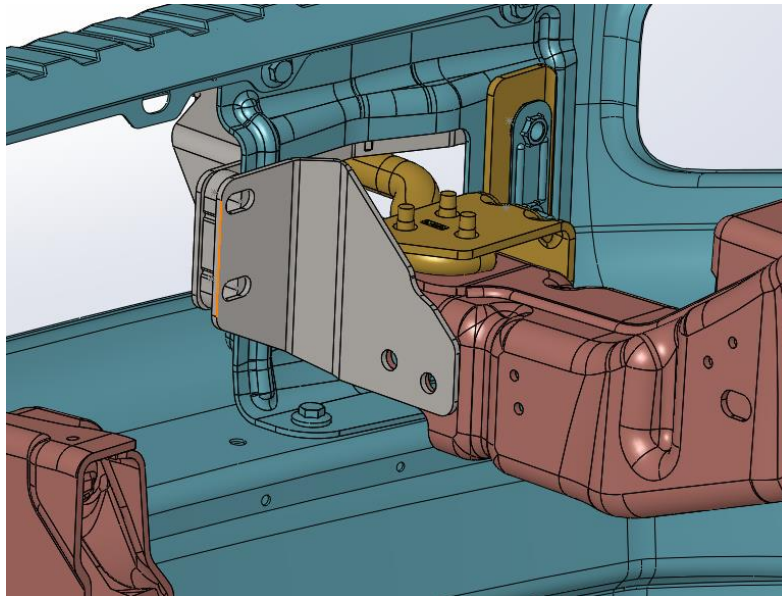

5. Lay down carpet or cardboard in front of truck. Lay Bull Bar as shown. Use hardware kit #92 to attach bull bar to frame mounts. Use one 3/8"-16 bolt, one 3/8" lock washer, and one 3/8" flat washer per hole. Install all bolts. Using a 9/16" socket with 3" extension, tighten all bolts. Use torque values on page one.



6. Have a friend help you align the Bull Bar. Push top of Bull Bar toward truck. Use torque values on page one. Verify top of Bull Bar is level with ground.



Congratulations! Your product installation is now complete.
Thank you for your purchase.